

REVISIONS
Lots 23A - 30 per Deeds, Field, Lec. C. Sh. 1224 & 1535.
Lot 31 per deed & Field Bowers Field C Sh. 1545C

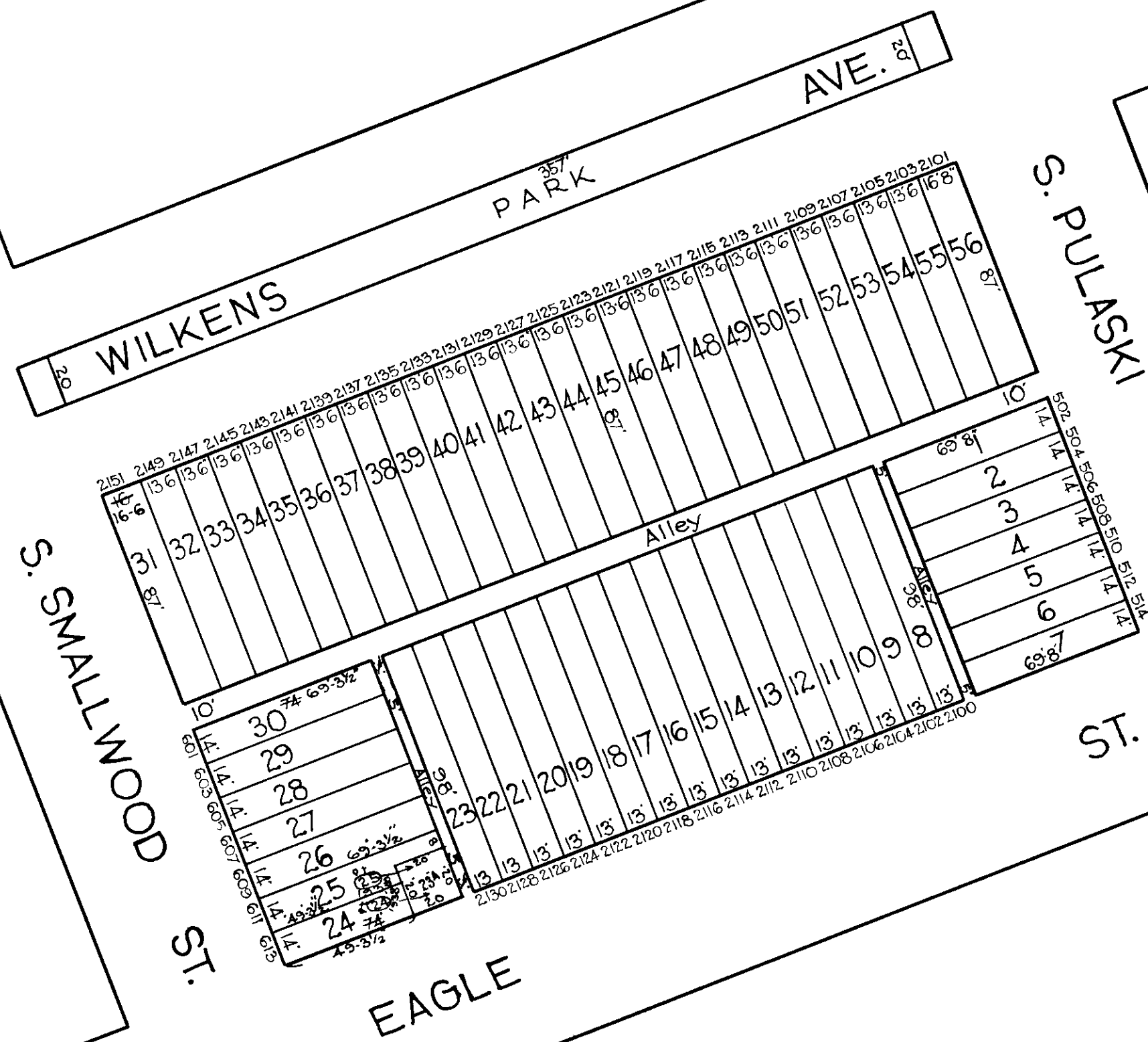

TRACED BY: R. LITZ
LETTERED BY: JQS J Rokosky
CHECKED BY:

NOTICE
THIS IS A REAL PROPERTY PLAT AS PROVIDED
FOR UNDER ARTICLE 76(d) OF THE CITY CHARTER
IT IS COMPILED FROM TITLE AND OTHER
SOURCES AND IS NOT AN AUTHENTIC SURVEY

CITY OF BALTIMORE
DEPARTMENT OF PUBLIC WORKS
BUREAU OF PLANS & SURVEYS
PROPERTY LOCATION DIVISION
WARD 20 SECTION 11
BLOCK 702
SCALE 1 IN. = 50 FT. DATE NOV. 1929